



广州飞傲电子科技有限公司

Guangzhou FiiO Electronics Technology Co.,Ltd.

广州市白云区黄石西路石岗村后岗工业区F栋2楼

WWW.fiiO.com

About FiiO

FiiO is a high-tech enterprise focusing on researching and developing portable music products, with current mainstay products being Hi-Res music players, portable headphone amplifier & DAC and headphones/earphones.

FiiO is specialized in self research and development, and sells FiiO-branded products through sales agents worldwide. By virtue of high quality products and great customer service, FiiO enjoys high reputation in the industry and has received countless well-known awards.

FiiO is committed to its brand proposition “Born for Music” and ceaselessly pursues perfection in product design and manufacturing, to supply users with the best audio products at the best prices.

Buttons and Ports Labeled

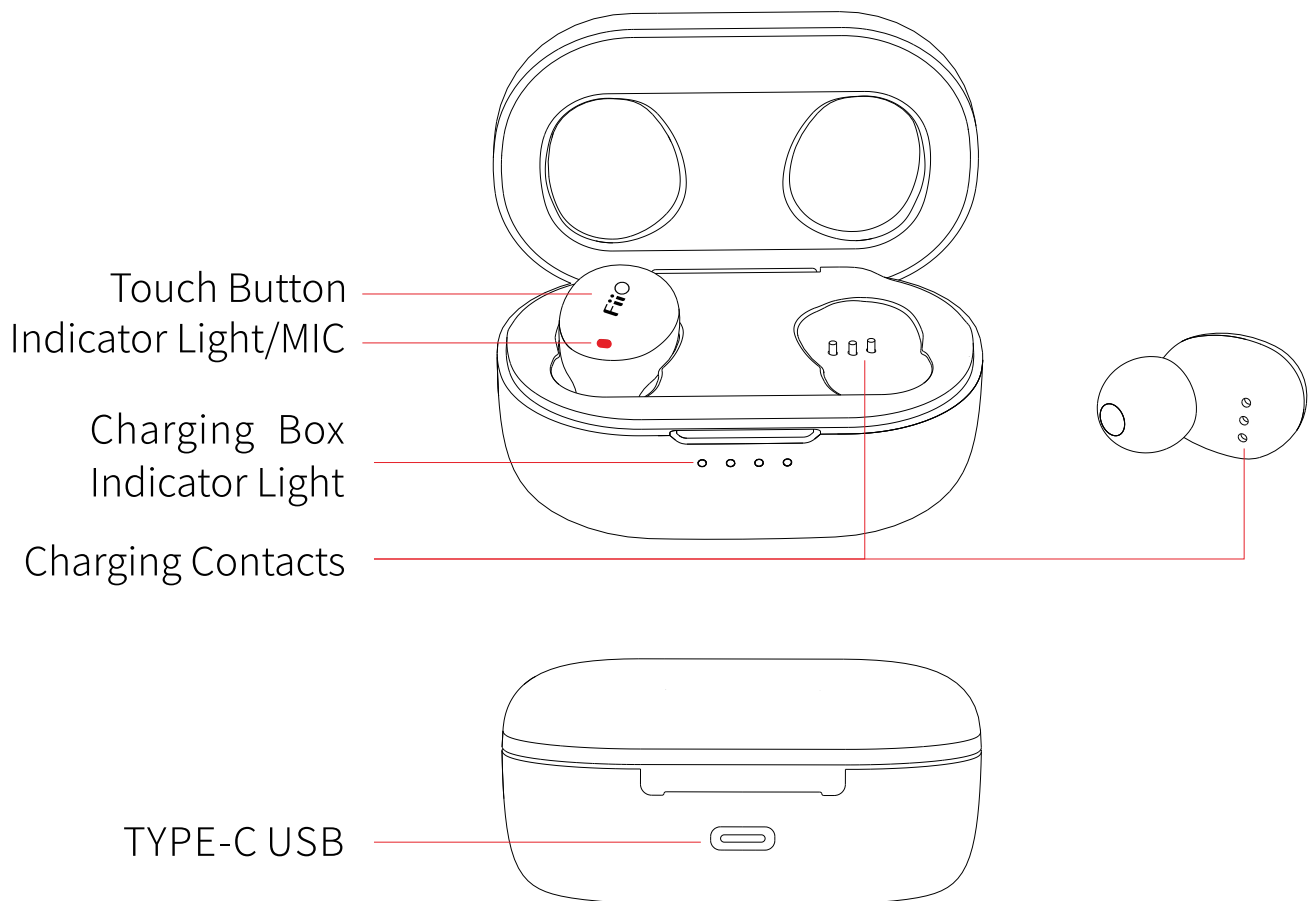

Operation Explained

1. Power on

- ① If the charging box is closed: when opening the box, with a prompt of "Power on", the FW1 will turn on automatically;
- ② If the charging box is opened: when taken the FW1 out of the box, with a prompt of "Power on", the FW1 will turn on automatically.

2. Power off

- ① If the FW1 is outside the box: put it into the box, it will turn off automatically;
- ② If the FW1 is inside the box: close the box so that the FW1 will turn off automatically.

3. Pairing

Left and right side pairing--both of the two sides will turn on automatically after opening up the charging box. First the left and right side will enter into peer device searching state. After a "Pairing successfully" prompt, the earbuds would enter into pairing state.

4. Playing devices pairing

- ① When the earbuds are on, it will reconnect the last connected device automatically. If it fails to reconnect, the earbuds will reenter into pairing state;
- ② When the earbuds are in the charging case and turned on, click either side 3 times in succession to force it enter pairing state;
- ③ Turn off the last-connected Bluetooth device to enter pairing mode.
Note: if the left and right sides are unable to connect, please clear pairing of both sides at the same time, and then pair them again.

5. Reconnection

- ① If the two sides of the earbuds are disconnected for distance surpassing, they could be reconnected once they are closed enough for the reconnection. However, if the new connection fails, it will automatically shut down after 5 minutes;
- ② If the connection between the earbuds and the playing device is cut for distance surpassing, they could be reconnected once they are closed enough for the reconnection. However, if the reconnection fails, the earbuds will enter into pairing mode which would last for 5 minutes. Later it would shut down without pairing;
- ③ If the earbuds turned off, long press the Touch Button for 2s to turn it on, and it will automatically reconnect to the last connected device. If it fails to reconnect, it will enter into pairing mode after 2 minutes.

6. Music playing

- ①Next track: when music is playing, long press the Touch Button on R side for 2 seconds to switch to the next song;
- ②Previous track: when music is playing, long press the Touch Button on L side for 2 seconds to switch to the previous song;
- ③Play/Pause: when music is playing, double click the Touch Button on R side to pause the playback; when the playback is paused, click the Touch Button on either side to resume music playback.

7. Volume operation

- ①Volume up: click the Touch Button on R side to increase the volume by one level at a time, until it hits the loudest volume with a "beep" sound;
- ②Volume down: click the Touch Button on L side to turn down the volume by one level at a time, until it hits the lowest volume with a "beep" sound.

8. Phone call

- ①Answer a call: when there is an incoming call, click the Touch Button on either side of the earbuds to answer the call;
- ②Hang up : during a phone call, long press the button on either side 2s to hang up the phone call;
- ③Decline a call: when there is an incoming call, long press the Touch Button on either side 2s to decline the phone call.

9. Clear pairing

Put the FW1 into the charging box, and long press the touch button of the left and right unit simultaneously for 8s until the blue light flashes rapidly. At this time, take the two earbuds out of the box and put them close to each other. It will automatically clear the pairing records and then enter pairing state.

Note: pairing records of both the left and right side need to be cleared simultaneously. Please keep the distance of both sides within 20cm, otherwise it will fail to pair.

Charging Instructions

- ①Low battery: when the remaining battery is less than 5%, the red light flashes every 1 minute with "Battery low, please charge" prompt until the battery runs out;
- ②Charging: put the earbuds into the charging box. It would charge the earbuds automatically with the red light constantly on, when the earbuds are fully charged, the red light will be off.

Charging box battery indicator light

● Light on ◐ Flashing ○ Off

Status		Box charging	Earbuds charging	Uncharged
Remaining battery	<25%	◐ ○ ○ ○ ○	◐ ○ ○ ○ ○	● ○ ○ ○ ○
	25-50%	● ◐ ○ ○ ○	◐ ◐ ○ ○ ○	● ● ○ ○ ○
	50-75%	● ● ◐ ○ ○	◐ ◐ ◐ ○ ○	● ● ● ○ ○
	75-100%	● ● ● ◐ ○	◐ ◐ ◐ ◐ ○	● ● ● ● ○
	100%	● ● ● ● ○		

Notices: if the charging box is not working, the indicator light will be on with the charging box opened while it will be off with the charging box closed.

Precautions

- ★ It's recommended to charge the device using a standard 5V charger or charger that could output 1A or above;
- ★ Please do not place the device in circumstances of excessive high/low temperature (above 45°C or below 0°C);
- ★ Bluetooth wireless technology has a working range of approximately 10 meters. Transmission distance is affected by obstacles (human, metal objects, walls, etc.) or electromagnetic environment and noise or audio loss may occur;
- ★ Prolonged use of high volume may result in permanent hearing loss. Switching between audio sources may cause a sudden change in volume. Please turn the earbuds to the low volume level before wearing the earbuds;
- ★ If the device is to be left unused for a long time, please recharge it periodically to preserve its battery life;
 - ★ Please do not disassemble, damage the battery, or drop it into fire; it is prohibited to continue using after the battery is soaked in water;
 - ★ Please do not wear earbuds when walking or riding to avoid accident.

Packing list

FW1-----1pair
TYPE-C USB Cable----- 1pcs
Charging box-----1pcs
Ear tips-----3 pairs
User Guide-----1 pcs

Warranty

1.FiiO provides one-month direct replacement guarantee and one year of free maintenance for product against defectives in material and workmanship under proper operation. (Specifics will be in accordance with the local laws and regulations; besides, you may be asked to provide proof of purchase for after-sales service, so keep your purchase invoice/receipt in a safe place.)

Note: The warranty service is applied to authentic product bought from FiiO authorized sales agents with valid security code. If it is unauthentic product, purchasers are bound to take all the responsibilities themselves.

2.The warranty is null and void under the following circumstances:

- ①Defects or damage caused by improper operations such as vibrating, bumping, falling to the ground, buckling, tearing, excessive pulling, etc;
- ②Defects or damage caused by disassembly of the product by user or unauthorized repair personnel;
- ③Defects or damage for being put in humid environment, high-intensity magnetic field or soaked into water;
- ④Defects or damage caused by natural disaster;
- ⑤Unable to provide valid proof of purchase, such as purchase invoice/receipt from FiiO authorized dealers;

Note: Man-made damage is determined by the judge of FiiO's maintenance personnel.

3.Free replacement or repair is only applied to earbuds, excluding any accessories or gifts.

Note: The above guarantees start from the issue date of the sales invoice/receipt. FiiO Company reserves the final interpretation and amendment for the above warranty terms.

Authenticity-Checking

Scratch off the coating to get a 20-bit security code. Please open this link: <http://check.fiio.com/>, and then enter your 20-bit security code.

Checking result:

1. The product you are checking is genuine. The product is manufactured by FiiO Company, thanks for choosing us.
2. The number you are checking does not exist. The product is not manufactured by FiiO Company.
3. The number has been checked. If this is the first time you enter the security code after scratching the coating personally, it means the product is not an authentic one.
4. The security code you input is less than 20 bits, please try again.

Procedures for After-sales Service

1. Please contact the local dealer first once you find problem in the machine, if they refuse to give related after-sales service, please give feedback to FiiO Company by sending email to support@fiio.com or support@fiio.net, we would handle it properly to ensure customers' satisfaction.
2. For repair maintenance, you are supposed to send the defective product to FiiO Company with freight paid. After it has been repaired, we will send the product back to you with freight paid by FiiO.
3. It is highly suggested to buy from local authorized sales agent to get better, faster before and after sales service.
4. Please do not maintain or dismantle the product on your own and keep it away from water.
5. In case of abnormal working or any further questions, please log in our official website at the Support area to get related information or send email to support@fiio.com to consult.

Contact Information for After-sales Service

FiiO Electronics Technology Co., Ltd.

Address: 2/F, F Building, Hougang Industrial Zone, Shigang Village, Huangshi West Road, Baiyun District, GuangZhou, China.

Postcode: 510430

Web: <https://www.fii.com>

Facebook: <https://www.facebook.com/FIIOAUDIO>

WEEE Directive & Product Disposal

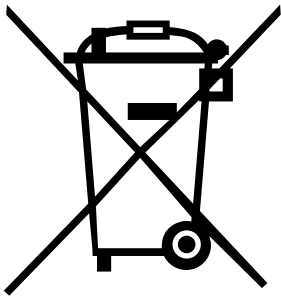

At the end of its serviceable life, this product should not be treated as household or general waste. It should be handed over to the applicable collection point for the recycling of electrical and electronic equipment, or returned to the supplier for disposal.

Internal/Supplied Batteries

This symbol on the battery indicates that the battery is to be collected separately.

This battery is designed for separate collection at an appropriate collection point.

This equipment has been tested and found to comply with the limits for a Class B digital device, pursuant to part 15 of the FCC Rules. These limits are designed to provide reasonable protection against harmful interference in a residential installation. This equipment generates, uses and can radiate radio frequency energy and, if not installed and used in accordance with the instructions, may cause harmful interference to radio communications. However, there is no guarantee that interference will not occur in a particular installation. If this equipment does cause harmful interference to radio or television reception, which can be determined by turning the equipment off and on, the user is encouraged to try to correct the interference by one or more of the following measures:

- Reorient or relocate the receiving antenna.
- Increase the separation between the equipment and receiver.
- Connect the equipment into an outlet on a circuit different from that to which the receiver is connected.
- Consult the dealer or an experienced radio/TV technician for help.

This device complies with part 15 of the FCC Rules. Operation is subject to the following two conditions: (1) This device may not cause harmful interference, and (2) this device must accept any interference received, including interference that may cause undesired operation.

Qualcomm aptX is a product of Qualcomm Technologies, Inc. and/or its subsidiaries. Qualcomm is a trademark of Qualcomm Incorporated, registered in the United States and other countries, used with permission. aptX is a trademark of Qualcomm Technologies International, Ltd., registered in the United States and other countries, used with permission.